

## SYMBOL KEY

-  VISITOR PARKING
-  METERED PARKING
-  MOTORCYCLE PARKING
-  BIKE RACK
-  CONFERENCE ROOM
-  ENTRANCE

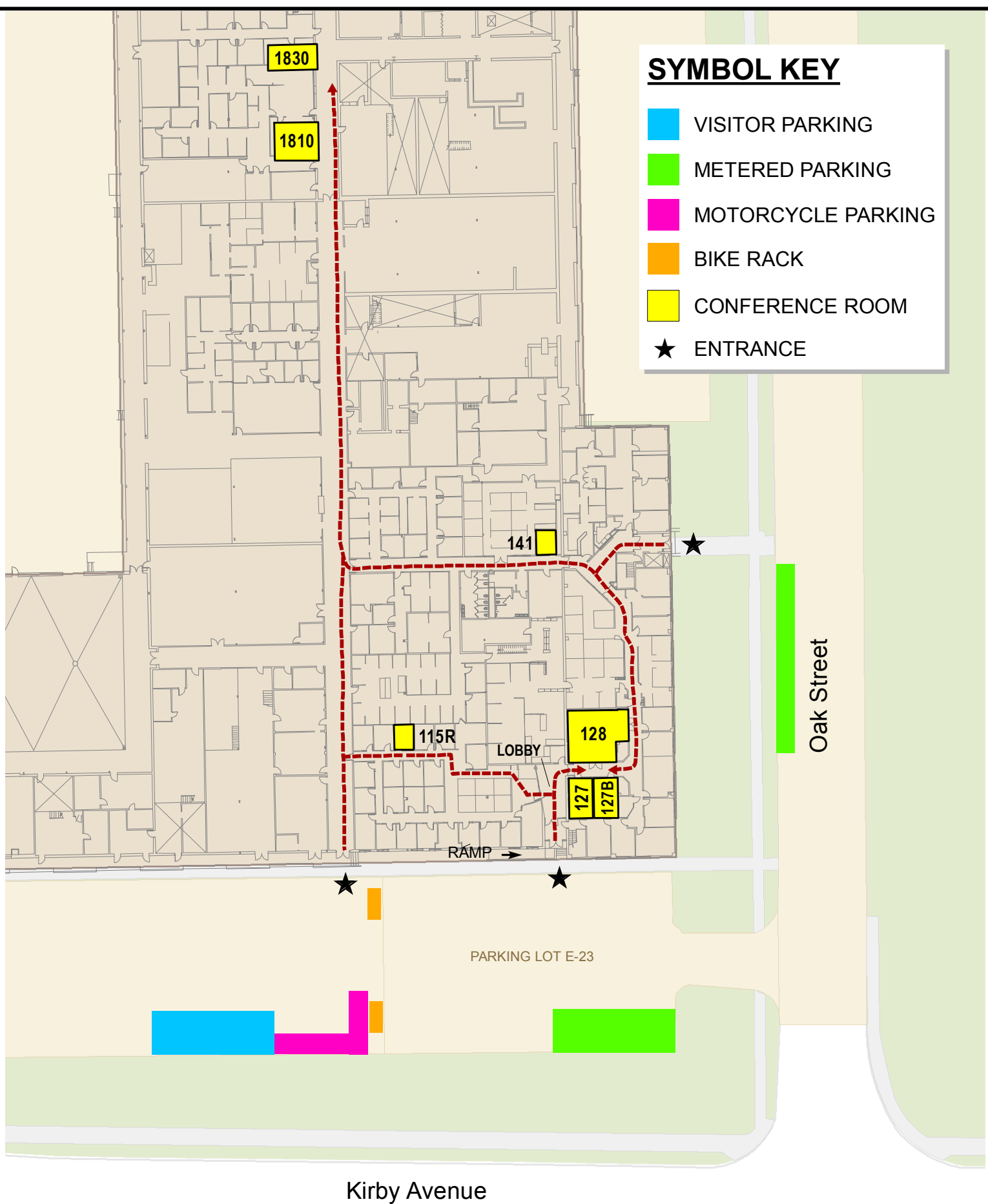

**PHYSICAL PLANT SERVICE BUILDING**

1501 South Oak Street, Champaign, IL 61820