



## TRANSPORTATION CLOSURE FORM (Streets, Sidewalks, Bike Paths & Bike Parking)

Date Submitted: 04/01/2026

Street(s), Sidewalks, Bike Path or Parking to be Closed: S. Goodwin Ave & sidewalk to building

Intersecting Streets which are affected or define limits of closure: W. Springfield Ave

Reason for Closure: Crane Operation

Project On-Site Contact Person: Brian Clark  
U of I Project Manager (PM): Hanzla Rafaqat

Phone Number: 217 840 1652  
U of I PM Phone Number: 217 954 3346

Date of Closure: 5/23/26

Expected Time of Closure: 06:00 AM

Date of Re-opening: 5/23/26

Expected Time of Re-opening: 04:00 PM

Work Order No. (if used): [Click or tap here to enter text.](#)

CDB Contract No.: U24025

Is Traffic re-routing necessary? Yes

If so, who should be involved? [Click or tap here to enter text](#)

Will Pedestrian/bicycle traffic be affected? Yes

If so, will the sidewalk be closed? Yes

Will ADA audible/visual warnings and barriers be provided? Yes

Will pedestrian traffic be routed safely? Yes

Are additional safety precautions needed? No

Please provide a diagram noting signage, re-routing, safety features, etc. with related explanations. **Diagram required.**

Yes    No



Is barricading required? If so, indicate the barricade locations on the diagram. You must contact the F&S Service Office to submit a barricade service request



Will Facility & Services staff place the barricades?  
If the barricades will be placed by others, give the name of person responsible and the telephone number: [Click or tap here to enter text.](#)



Will police be necessary to direct the traffic? If so, name jurisdiction times, dates and location of each officer needed: [Click or tap here to enter text.](#)



Will this street closure affect University of Illinois parking meters on the street or in the parking lots in this area?  
If so, you **MUST** contact the Parking Department at 333-3530 as there may be a fee assessed.



Will MTD, DRES or other bus route re-locations be necessary? If so, coordinate with affected agency.  
Record name and date of discussion with agency representative: [Click or tap here to enter text.](#)



Will deliveries be permitted? **If so, how will access be controlled?** Flaggers will assist in directing traffic and guiding delivery vehicles as needed.

4/22/2026

*Sarthak Prasad*

Sarthak Prasad on behalf of Stacey DeLorenzo

Date approved: [Click or tap to enter a date.](#) Approved By: [Click or tap here to enter text.](#)

Transportation Systems Manager (TSM): Stacey DeLorenzo · Phone: (217) 300-1750 · [fandscampustdm@illinois.edu](mailto:fandscampustdm@illinois.edu)

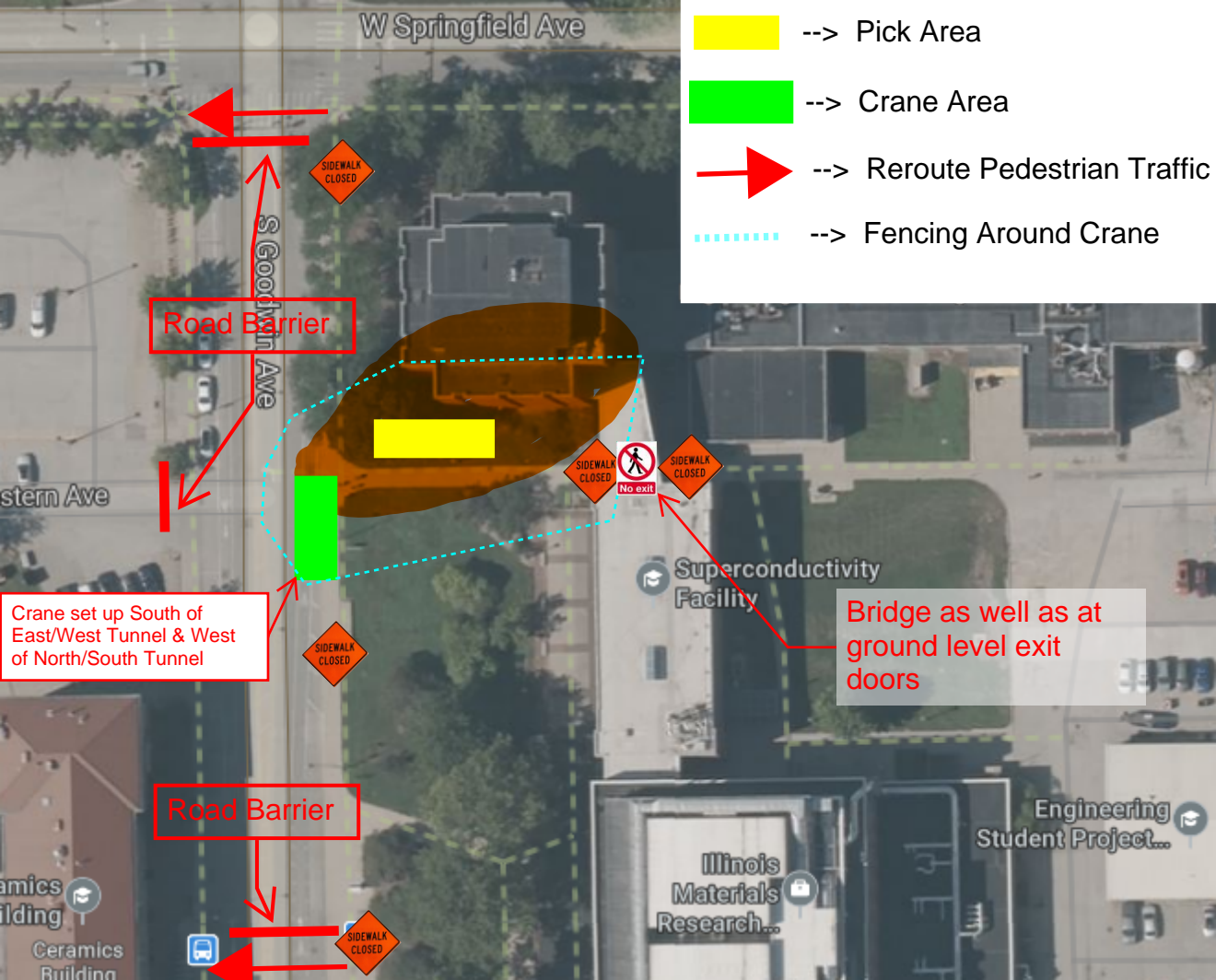

W Springfield Ave

 --> Pick Area

 --> Crane Area

 --> Reroute Pedestrian Traffic

 --> Fencing Around Crane

Road Barrier

S Cookman Ave

SIDEWALK CLOSED

SIDEWALK CLOSED

No exit

SIDEWALK CLOSED

Western Ave

Superconductivity Facility

Crane set up South of East/West Tunnel & West of North/South Tunnel

SIDEWALK CLOSED

Bridge as well as at ground level exit doors

Road Barrier

Ceramics Building

Ceramics Building



SIDEWALK CLOSED

Illinois Materials Research...

Engineering Student Project...